

COMPONENTS INCLUDES:

- HANDLE
- CANOPY
- DETACHABLE CARRIAGE
- STORAGE BASKET
- FOOT BOARD
- REAR WHEEL
- FRONT WHEEL

CLEANING AND MAINTENANCE:

STEP 1: UNSNAP BUTTON ON STROLLER

STEP 2: TAKE APART THE CANOPY

STEP 3: REMOVE THE CUSHION

STEP 4: WIPE STROLLERS GENTLY



-pet stoller- URBAN STRIDER

INSTRUCTION MANUAL



WARNING

For accurate structure and to avoid injury to yourself, your pet or your home please read care guides, books and research quality care outside of these instruction manuals. Contact a pet professional with any additional care questions.

For questions and inquiries please contact our customer service email: customerservice@pawsandpals.com

- FOR PETS ONLY
- Not intended to be used as a restraining device for aggressive or dangerous animals that dig, chew or paw aggressively.
- Do not leave your pet unattended.
- Paws & Pals® is not liable for any damage caused by aggressive, destructive, immature or untrained animals.
- Do not use near an open or exposed flame.
- Failure to follow these warnings and the instructions could result in serious injury or death.
- Always apply the brake whenever the stroller is stationary.
- Do not overload as stroller may become unstable; maximum weight capacity is 33 pounds.
- This stroller is designed for one pet only.
- Before making adjustments to stroller ensure that your pet's body is clear of any moving parts.
- Do not hang bags from handles as this may cause the product to become unstable.
- Do not use on escalator or stairs; fold stroller and carry.
- Ensure stroller is completely erected and check that all locks are engaged before placing pet in stroller.



PAWS & PALS®
LOS ANGELES, CA
PAWSANDPALS.COM

FOR CATS & DOGS

MAX WEIGHT: 33 LBS.



1. CARRIAGE ASSEMBLY: Push the bar frames inside of the carriage to the outer ends so it props up the carriage.

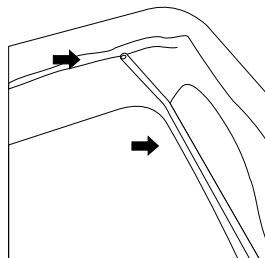

2. PADDING PLACEMENT: Place the padding inside of the carriage.

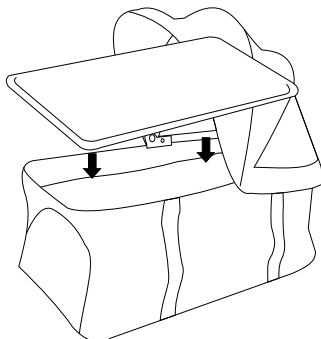

3. EXTRA SAFETY FEATURE: Slip each of the two hooks through the holes in the cover. Zip up the cover.

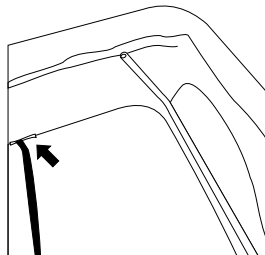

4. INSTALLING CANOPY: Place the sunshade on top of the carriage. The sunshade should be placed on the opposite end of the mesh opening. The hooks should fasten on each side. The carrying straps for the carriage should be placed on the outside when placing the sunshade on the carriage.

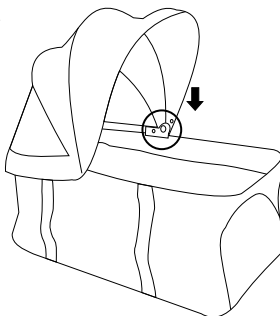

5. FRAME ASSEMBLY: From the handle, pull the frame up as much as possible.

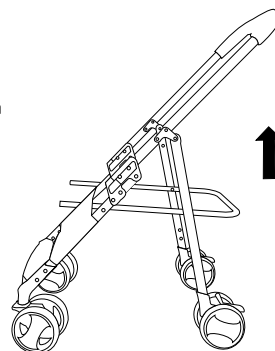

6. OPERATING BRAKES: To lock the frame, place your foot on the rear pole of the frame while continuing to pull the handle up. The frame is locked in place when you hear a snap sound.

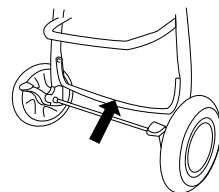

7. INSTALLING THE FRONT & BACK WHEEL: Place the rear wheels onto the frame. The rear wheels are designated by having the emergency brake. Align the tube with the frame and insert until you hear a snap sound. Repeat for the front wheels.

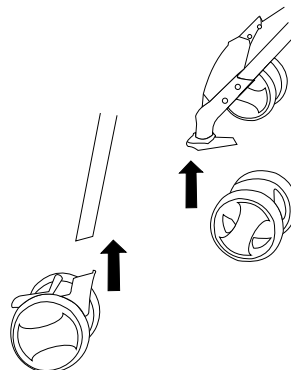

8. INSTALLING CARRIAGE: Place the carriage onto the frame. The two sleeves on the bottom front of the carriage should slip into the poles on the frame. Fasten the rear of the carriage to the frame by running the Velcro flap over the pole.

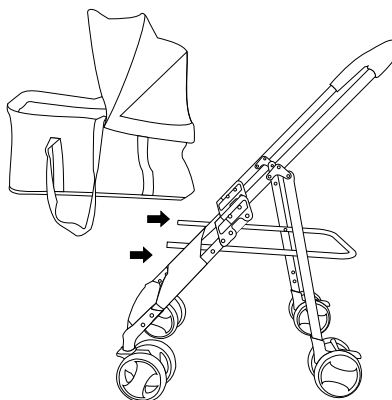

1. FOLDING THE FRAME: Turn on the emergency rear wheel brakes. Press the brake down on each rear wheel to lock. With the front wheels parallel, press up on the brake to lock.

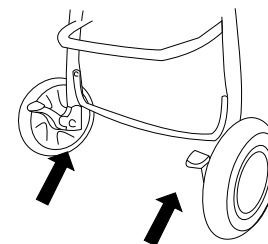

2. Slide the unlock button on the top of the handle to the left toward the unlock icon.

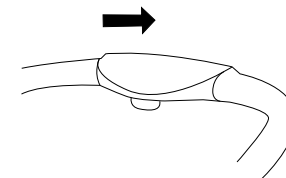

3. With the Unlock Button slid to the left, press the release button and push the frame down.

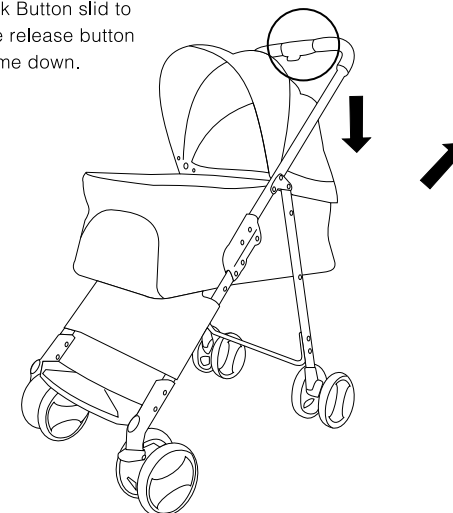

4. Removing the carriage from the frame is optional and can be done before or after folding the frame. To remove the carriage, unfasten the Velcro from the rear of the frame. Slide the carriage forward to free it from the frame.

