

⚠ WARNING

For accurate structure and to avoid injury to yourself, your pet or your home please read care guides, books and research quality care outside of these instruction manuals. Contact a pet professional with any additional care questions.

For questions and inquiries please contact our customer service email: help@pawsandpals.com

- Product use is at one's risk. Paws & Pals™ is not liable for any damages or injuries resulting from construction, use or misuse of this product or because of failure to comply with these instructions. The Paws & Pals Portable Stroller cannot be used for any use outside of these instructions.
- Keep out of reach of pets and children during assembly.
- Only pets are allowed inside of the carriage.
- Children under 4 feet should not push the stroller.
- Children should be under adult supervision if using the stroller.
- Not for use as a toy or trailer.
- Children, those with a heart condition or illness, and women who are pregnant should not build this item.
- Keep the item on a level ground when installing and during use to avoid tipping or falling. The carriage and wheels should be locked in an equal center of gravity.
- Avoid traveling at a high speed or on bumpy surfaces.
- The bottom basket is not intended to carry pets.
- Do not place hazardous materials in or near the stroller.
- Construction of the stroller will cause static buildup over time. Stay grounded and discharge static in a safe location during and after construction of the stroller.
- DON'T leave your pet unattended.
- Paws & Pals™ is not liable for any damage caused by aggressive, destructive, immature or untrained animals.
- DON'T use near an open or exposed flame or in high-temperature environments.
- Failure to follow these warnings and instructions could result in serious injury or death to you or your pet.
- Apply the brakes whenever the stroller is stationary.
- DON'T overload the stroller. The maximum weight capacity is 33 pounds.
- This stroller is designed for one (1) pet only.
- Keep pet away from the stroller when making adjustments.
- DON'T hang bags or handles from the stroller, as this may cause the stroller to become unstable.
- DON'T use on escalators or stairs. When on escalators or stairs, fold the stroller and carry it with you.
- Before placing your pet inside of the carriage, secure all locks and poles on the stroller.
- DON'T attach your pet's leash to any part of the stroller as it could cause tangling.

NOTES BEFORE AND DURING INSTALLATION

- A SMALL PHILLIPS SCREWDRIVER IS REQUIRED TO INSTALL THE FOOTBOARD.
- EXTRA PRESSURE MIGHT BE NEEDED TO SECURE THE REAR WHEELS IN THEIR PLACE. IF NEEDED, STAND THE STROLLER UPRIGHT AND APPLY HAND PRESSURE FROM THE BASE OF THE CARRIAGE TO LOCK IN THE REAR WHEELS.
- THE PET STROLLER CAN BE FOLDED FOR STORAGE. HOWEVER, ONCE THE WHEELS ARE IN PLACE, THEY CANNOT BE DETACHED.
- THE CUP HOLDER IS OPTIONAL. HOWEVER, TO HAVE THE CUP HOLDER INSTALLED, THE RED HOOK WILL NEED TO BE DETACHED COMPLETELY.
- THE LOCKS AND HOOKS THAT SECURE THE CARRIAGE AND WHEELS ARE POTENTIAL PINCH AREAS. KEEP FREE FINGERS AND TOES AWAY FROM THESE AREAS DURING ASSEMBLY OR STORAGE.
- MAXIMUM LOAD IS 33 POUNDS.
- ESTIMATED ASSEMBLY TIME: 30 MINUTES.

PAWS & PALS
just for them



PAWS & PALS
just for them

3 WHEEL

PET STROLLER
INSTRUCTION MANUAL

PAWS & PALS ©
LOS ANGELES, CA
(800) 613-5358
PAWSANDPALS.COM

ACCESSORIES LIST

- A - FRONT WHEEL (1 PC)
- B - REAR WHEEL (2 PCS)
- C - REAR WHEEL ROD (1 PC)
- D - STROLLER (1 PC)
- E - CUP HOLDER (1 PC)
- F - RED HOOK (1 PC)
- G - SCREWS (5)
- H - REAR WHEEL CAP (2 PCS)
- I - GASKETS (5 PCS)
- J - FOOTBOARD (1 PC)

MAINTENANCE: TO PREVENT YOUR PET FROM BEING INJURED BEFORE, DURING OR AFTER USE, CHECK AND MAINTAIN THE STROLLER.

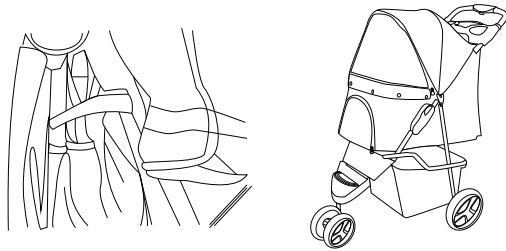

PRE-ASSEMBLY: CHECK FOR ALL PARTS. UNWRAP ALL PLASTIC COVERING FROM THE POLES, WHEELS AND CARRIAGE. DETACH THE RED HOOK FROM THE STROLLER AND UNFOLD THE STROLLER.

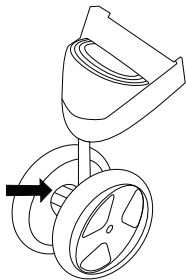

FRONT WHEEL: WITH THE STROLLER LYING ON ITS SIDE, INSERT THE FRONT WHEEL. THE FRONT WHEEL HAS AN ARROW ON THE CENTER AXIS, AND THE ARROW SHOULD POINT UPWARD WHEN INSTALLING. THE WHEEL IS SECURED WHEN A SNAP IS HEARD OR FELT. TO LOCK THE WHEEL IN PLACE, SNAP THE RED LATCH UP.

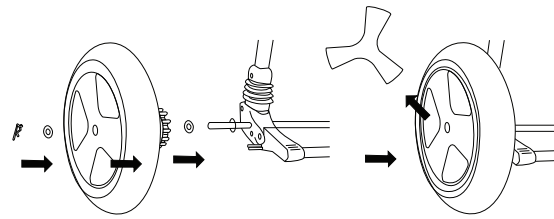

REAR WHEELS: DETACH THE SMALL WIRE FROM ONE SIDE OF THE REAR WHEEL FRAME AND TAKE OUT ONE GASKET. INSERT ONE REAR WHEEL ON THE FRAME, THE BRAKE GROOVES GOING INWARD. INSERT THE GASKET FOLLOWED BY THE SMALL WIRE TO SECURE THE WHEEL. REPEAT FOR THE OTHER WHEEL ON THE OTHER SIDE OF THE FRAME. INSERT THE WHEEL COVER ON EACH OF THE REAR WHEELS. WITH BOTH REAR WHEELS SECURED ON THE FRAME, INSERT THE FRAME ONTO THE BACK OF THE STROLLER. THE RED BRAKES SHOULD BE POINTING BACKWARD.

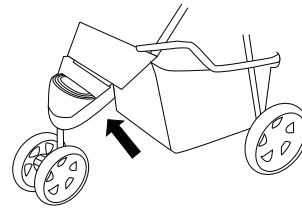

FOOTBOARD: WITH THE STROLLER LYING ON ITS SIDE, PLACE THE FOOTBOARD ON THE FRONT OF THE STROLLER. SECURE WITH SCREWS AND GASKETS ON EACH OF THE FOUR HOLES.

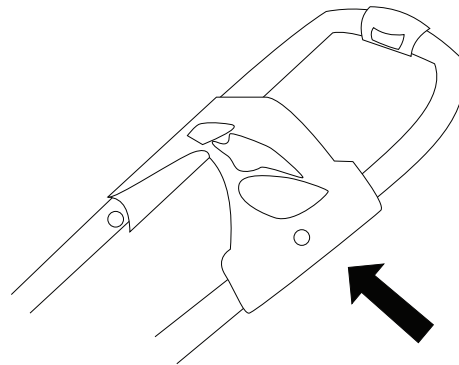

CUP HOLDER: INSERT THE HOLE ON THE LEFT SIDE OF THE CUP HOLDER TO THE KNOB ON THE LEFT OF THE STROLLER. REPEAT FOR THE RIGHT HOLE FOR THE KNOB ON THE RIGHT SIDE.

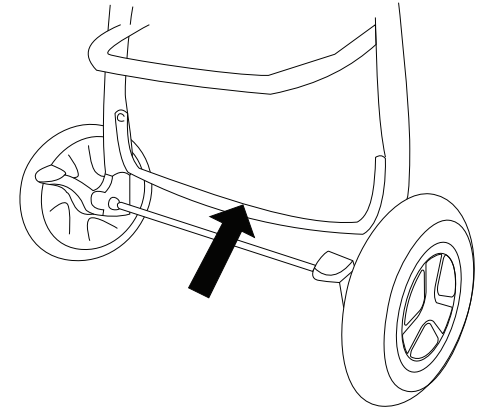

BASKET: SNAP THE BUTTONS ON THE BACK OF THE BOTTOM BASKET TO THE BOTTOM POLE. HOOK THE FRONT OF THE BASKET TO THE POLES TO PROP UP THE BASKET.

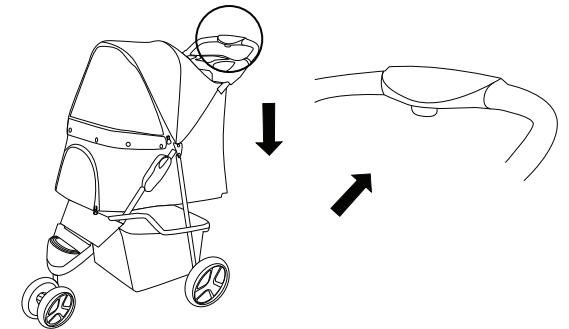

STORAGE: TO FOLD THE STROLLER, UNZIP THE CARRIAGE. PULL BOTH HOOKS ON THE SIDE OF THE CARRIAGE AT THE SAME TIME. USE THE HANDLE FROM THE STROLLER TO GENTLY PUSH DOWN UNTIL IT IS COMPLETELY FOLDED. USE THE RED HOOK TO LOCK THE STROLLER IN ITS FOLDED POSITION. NEVER LIFT THE STROLLER AFTER DETACHING IT. PETS SHOULD BE OUT OF THE CARRIAGE AND AWAY FROM THE STROLLER WHEN FOLDING.